

F

THE CITY OF NAPOLEON

BUILDING & ZONING DEPARTMENT

255 W. RIVERVIEW

(419) 592-4010

Building Permit

Permit Number: BP2008-60

Page 1 of 1

Printed: 5/27/2008

ADDRESS:

915 Lombard St.

Applicant

Name: Robert Bennett
Address: 915 Lombard St

Approval Date: 5/27/2008
419-592-0060

Owners

Name: Mr. Robert Bennett
Address: 915 Lombard St
Napoleon, OH 43545

Phone: 419-592-0060

Contractors

Fees and Receipts:

Number	Description	Amount
FEE2008-304	Building Permit Fee (Auto)	\$10.00
FEE2008-305	State 1% fee (Calc)	\$0.10
Total Fees:		\$10.10
RCPT2008-193		\$10.10
Total Receipts:		\$10.10

privacy fence

APPLICANTS SIGNATURE: _____ DATE: _____

REMINDER: YOU MUST CALL (419)592-4010 FOR AN INSPECTION

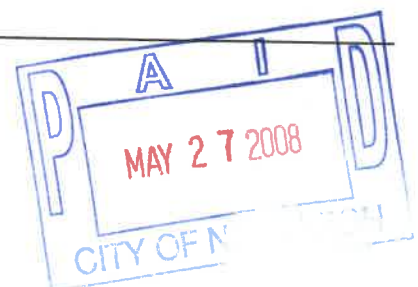

CITY OF NAPOLEON GENERAL PERMIT APPLICATION

THIS APPLICATION IS FOR RESIDENTAL CONSTRUCTION INCLUDING BUILDING, ELECTRICAL, PLUMBING, MECHANICAL, DEMOLITIONS, REMODELING.

DATE: 05/23/08 JOB LOCATION: 915 Lombard ST

OWNER: Robert Bennett PHONE: 419-592-0060

OWNER ADDRESS: 915 Lombard CITY: NAP ZIP: 43515

CONTRACTOR: SELF

PHONE #: same CELL PHONE# 419-579-4106

CONTRACTOR LICENSED WITH THE CITY OF NAPOLEON?: YES NO:

Is any of the above job going to be subcontracted out? Yes No:

If yes to whom: _____

DESCRIPTION OF WORK TO BE PERFORMED: INSTALL WOOD PRIVACY FENCE ON REAR LOT LINE

ESTIMATED COMPLETION DATE: 5-31-08

PLEASE MARK THE TYPE OF WORK YOU WILL BE PERFORMING

- | | |
|--|---|
| <input type="checkbox"/> A/C ADD ON 1% | <input type="checkbox"/> REMODELING 1% |
| <input type="checkbox"/> BOILER REPLACEMENT 1% | <input type="checkbox"/> ROOFING 1% |
| <input type="checkbox"/> CURBING | <input type="checkbox"/> SEWER REPAIRS** |
| <input type="checkbox"/> DECKS * 1% | <input type="checkbox"/> SIDEWALK* |
| <input type="checkbox"/> DRIVEWAY* | <input type="checkbox"/> SIDING 1% |
| <input type="checkbox"/> ELECTRICAL SERVICE UPGRADE 1% | <input type="checkbox"/> SHED* (under 200 sq ft) |
| <input type="checkbox"/> ELECTRICAL SERVICE NEW 1% | <input type="checkbox"/> SHED* (over 200 sqft) 1% |
| <input type="checkbox"/> SWIMMING POOL* 1% | <input checked="" type="checkbox"/> FENCE* |
| <input type="checkbox"/> FURNACE REPLACEMENT 1% | <input type="checkbox"/> TEMP ELECTRIC 1% |
| <input type="checkbox"/> ADDITIONS* 1% | <input type="checkbox"/> FURNACE NEW 1% |
| <input type="checkbox"/> WATER TAP (size _____") | <input type="checkbox"/> WINDOWS /DOORS 1% |
| <input type="checkbox"/> LAWN METER 1% | |
| <input type="checkbox"/> PLUMBING 1% | |

1%- EFFECTIVE JUNE 1, 2007 BOARD OF BUILDING STANDARDS FEE

*PLEASE INCLUDE A PICTURE SHOWING MEASUREMENTS FROM EXISTING STRUCTURES AND PROPERTY LINES. INDICATING THE TYPE OF WORK YOU WISH TO PERFORM.

** IF WORK REQUIRES GOING INTO THE STREET A STREET BOND IS REQUIRED!

FOR PERMIT COSTS PLEASE FILL OUT REVERSE SIDE.

BP08-60 \$10¹⁰

PERMIT COST WORKSHEET

1%

JOB _____ **BASE FEE** _____ **TOTAL + BBS FEE = PERMIT TOTAL** _____

SIDING (only) TOTAL SQ _____ X 1.00 = _____ + \$5.00 = \$ _____ + \$ _____ = \$ _____
ROOFING (only) TOTAL SQ _____ X 1.00 = _____ + \$5.00 = \$ _____ + \$ _____ = \$ _____
WINDOWS / DOORS(only) # _____ X 1.00 = _____ + \$5.00 = \$ _____ + \$ _____ = \$ _____
ELECTRICAL # OF CIRCUITS _____ X 3.00 = _____ + \$15.00 = \$ _____ + \$ _____ = \$ _____
ELECTRICAL SERVICE UPGRADE \$15.00 = \$ _____ + \$ _____ = \$ _____
PLUMBING (INSIDE) replacing/ repairs \$10.00 = \$ _____ + \$ _____ = \$ _____
SEWER (OUTSIDE) \$25.00 = \$ _____ + \$ N/A = \$ _____
WATER HEATER \$5.00 = \$ _____ + \$ _____ = \$ _____
SHED UNDER 200 SQ FT (over 200 see chart) \$ 5.00 = \$ _____ + \$ N/A = \$ _____
FURNACE OR A/C (REPLACEMENT) \$ 5.00 = \$ _____ + \$ _____ = \$ _____
DEMOLITION (only) \$30.00 = \$ _____ + \$ N/A = \$ _____
SIDEWALK REPLACEMENT/ NEW \$25.00 = \$ _____ + \$ N/A = \$ _____
DRIVEWAY \$25.00 = \$ _____ + \$ N/A = \$ _____

ALL CONSTRUCTION, ALTERATIONS, REMODELING, SHEDS, DECKS, & FENCES NOT LISTED ABOVE IS BASED ON COST OF WORK BEING PERFORMED.D.

COST OF WORK \$ 777 PERMIT FEE (SEE CHART) \$ 10.00 + \$ - = \$ 10.00

0.00	-	250.00	0.00	11,000.00	-	11,999.00	25.00
250.00	-	999.00	10.00	12,000.00	-	12,999.00	26.00
1,000.00	-	1,999.00	12.00	13,000.00	-	13,999.00	27.00
2,000.00	-	2,999.00	14.00	14,000.00	-	14,999.00	28.00
3,000.00	-	3,999.00	16.00	15,000.00	-	15,999.00	29.00
4,000.00	-	4,999.00	18.00	16,000.00	-	16,999.00	30.00
5,000.00	-	5,999.00	19.00	17,000.00	-	17,999.00	31.00
6,000.00	-	6,999.00	20.00	18,000.00	-	18,999.00	32.00
7,000.00	-	7,999.00	21.00	19,000.00	-	19,999.00	33.00
8,000.00	-	8,999.00	22.00	20,000.00	-	20,999.00	34.00
9,000.00	-	9,999.00	23.00	21,000.00	-	21,999.00	35.00
10,000.00	-	10,999.00	24.00	22,000.00	-	22,999.00	36.00
				Over 22,999		Please Call	

** OTHER FEES NOT LISTED MAY APPLY

TOTAL PERMIT COSTS \$ _____

**THE CITY OF NAPOLEON
BUILDING & ZONING DEPARTMENT
255 W. RIVERVIEW
(419)592-4010**



Inspections

Page 1 of 1

Address: 915 Lombard St.
Napoleon, OH 43545

Printed: 6/6/2008

Applicant: Robert Bennett

Permit Number: BP2008-60

Inspection Date: 6/6/2008
Inspection Number: INSP2008-114
Inspection Type: Building Final

Inspector: Tom
Status: Approved
Passed?

Required Steps:

Comments:

Other Fields:

05/23/08

6 Ft High Privacy Fence
Sh Adorn Bon Style.

915

921

8" San.

Lumbarda



19th Street

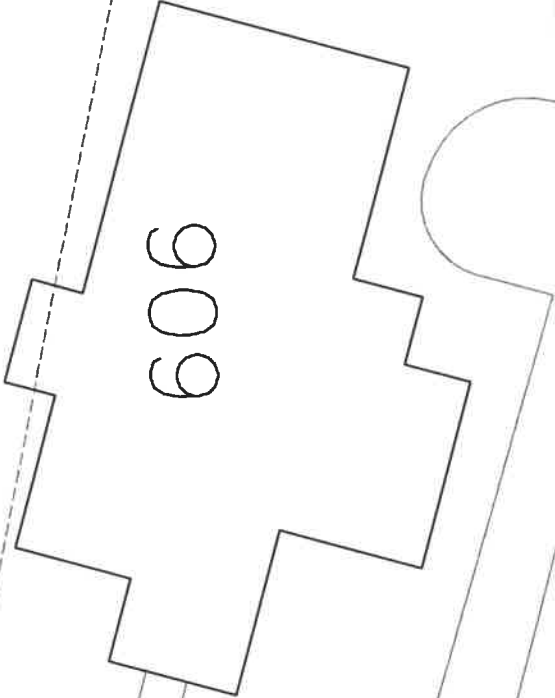
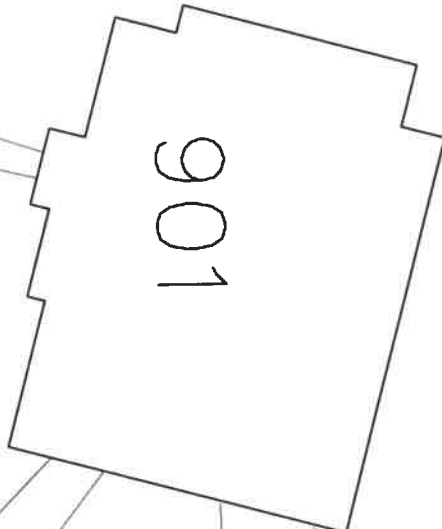

4" W.M.

A blue line with asterisk markers at intervals, representing a utility line (likely water main) running horizontally across the middle of the diagram. A yellow circle is connected to this line by a yellow line.

